

ADAIR HOMES

the **PARKER**

2,256 SF | 4 Bed | 2.5 Bath



CRAFTSMAN



the PARKER

2,256 SF | 4 BED | 2.5 BATH

- Open Kitchen & Great Room
- Optional Vaulted Master Suite
- Shop Space in the Garage
- Large Utility Room
- Covered Front Porch
- Optional Shake Exterior

EXTERIOR ELEVATION OPTIONS



View all elevation options at www.AdairHomes.com

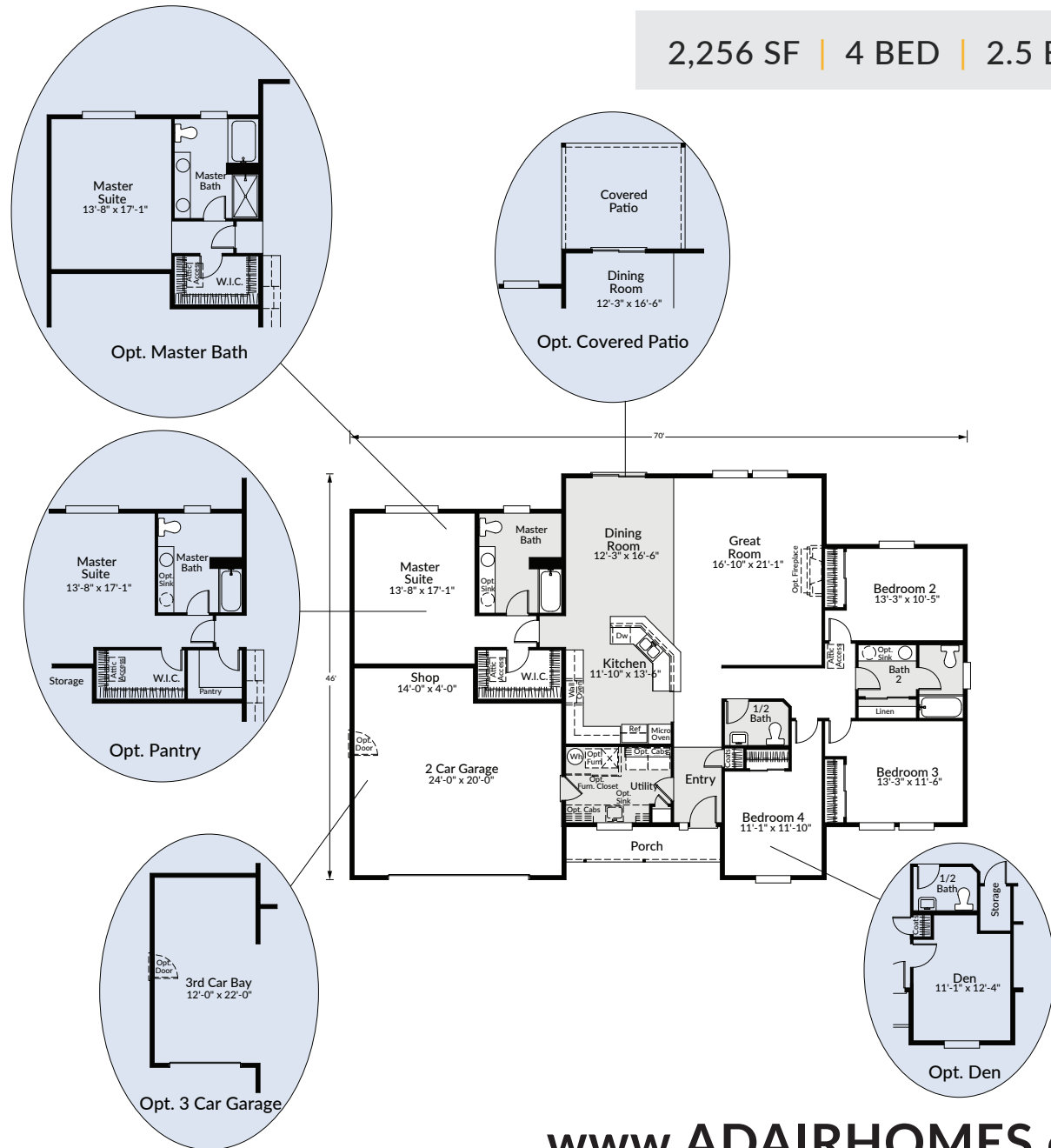

www.ADAIRHOMES.com

